

REV	MARK	HISTORY	DATE	NAME
REV. 0	—	—	2017. 01. 04	JSY

正视图

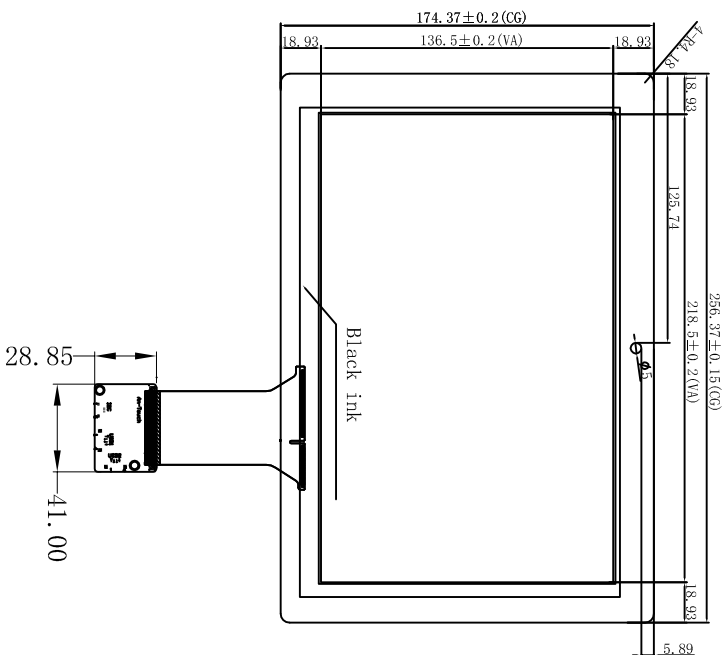

侧视图



背视图

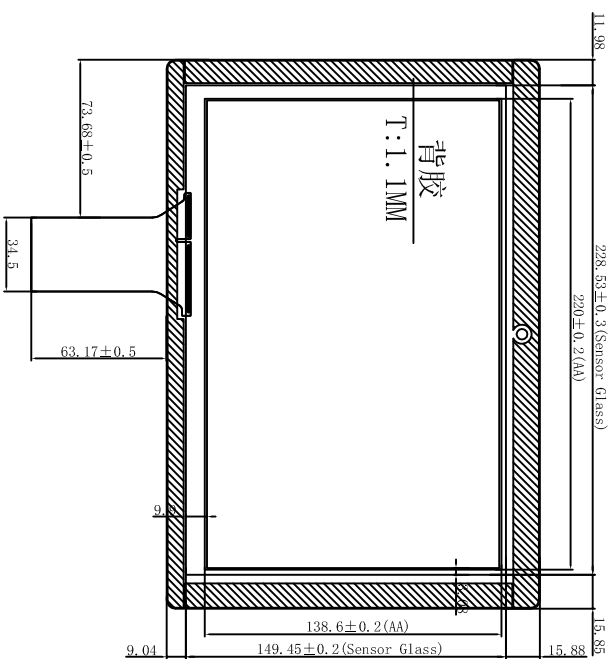

Notes:

1. TP Structure: G+G;
2. TP Type: COB; IC: ILITEK2511
3. Transmittance: ≥85%
4. Hardless: >6H
5. Operating conditions: -10°C~+60°C, ≤85%RH
6. Storage conditions: -10°C~+65°C, ≤85%RH
7. Unspecified tolerance: ±0.2mm
8. All materials in the drawing comply with the Rosh

AC-K1336-10.1 Drawing		SHEET	UNIT	SCALE	1st ANGLE PROJECTION
		1 of 1	m m	1 : 1	
DESIGN	DATE				
CHECK	DATE				
JSY	2017. 03. 04				

PN	定义	PN	备注
1	33V	2	33V
2	VDD/SV	3	SIN 33V
3	D-	4	INT
4	D+	5	IND
5	IND	6	RST
6	IND		